

## Create a Shoe Car

In The Stroogle's New Home the four friends build their own shoe car out of rubbish. You too can make your very own little shoe car like the example below. Choose the parts from the sheets and cut and paste them together on a blank sheet of paper placed long ways so your picture fits. Once the glue has dried you can colour your car in.

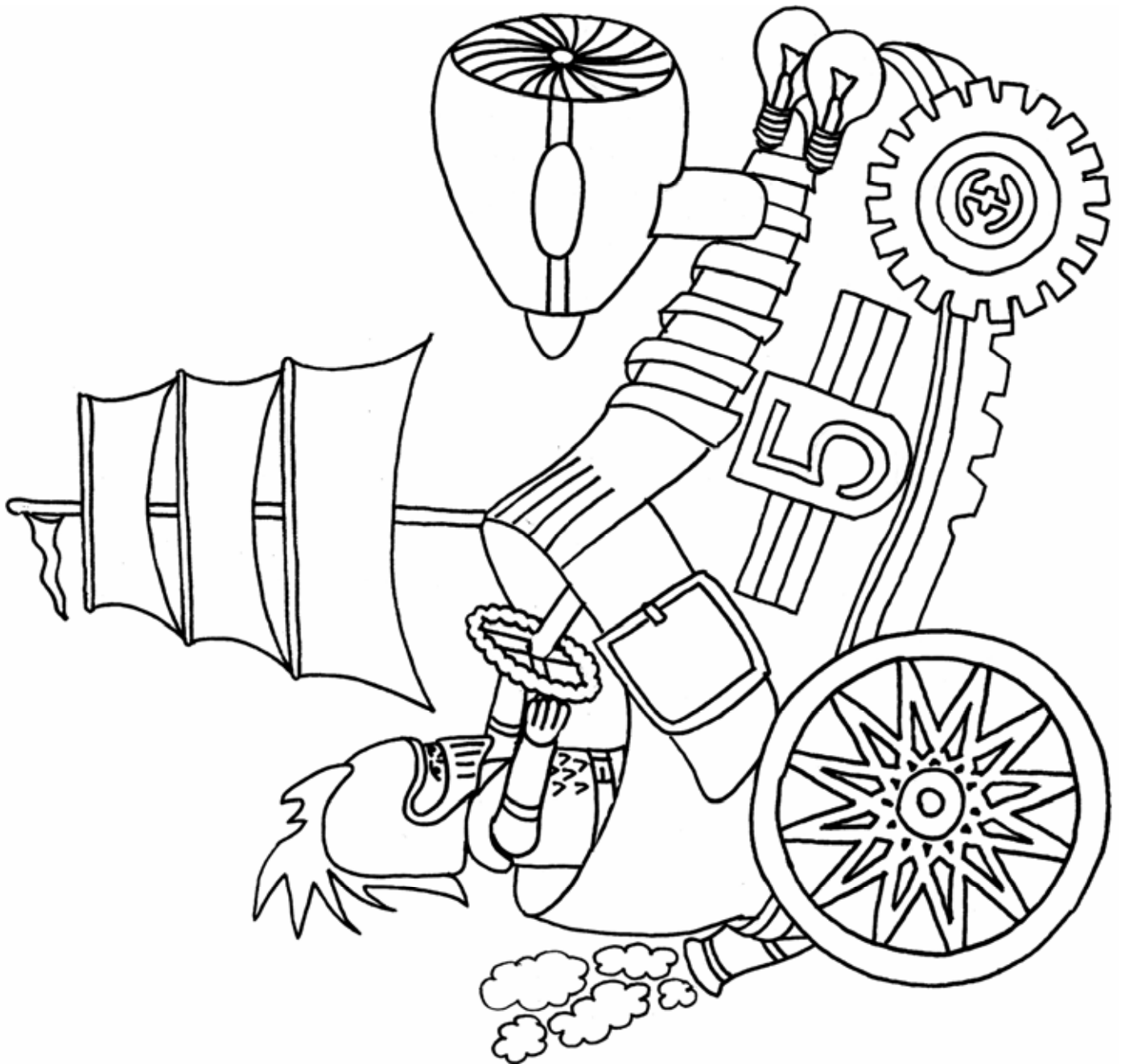

## SHOES 1

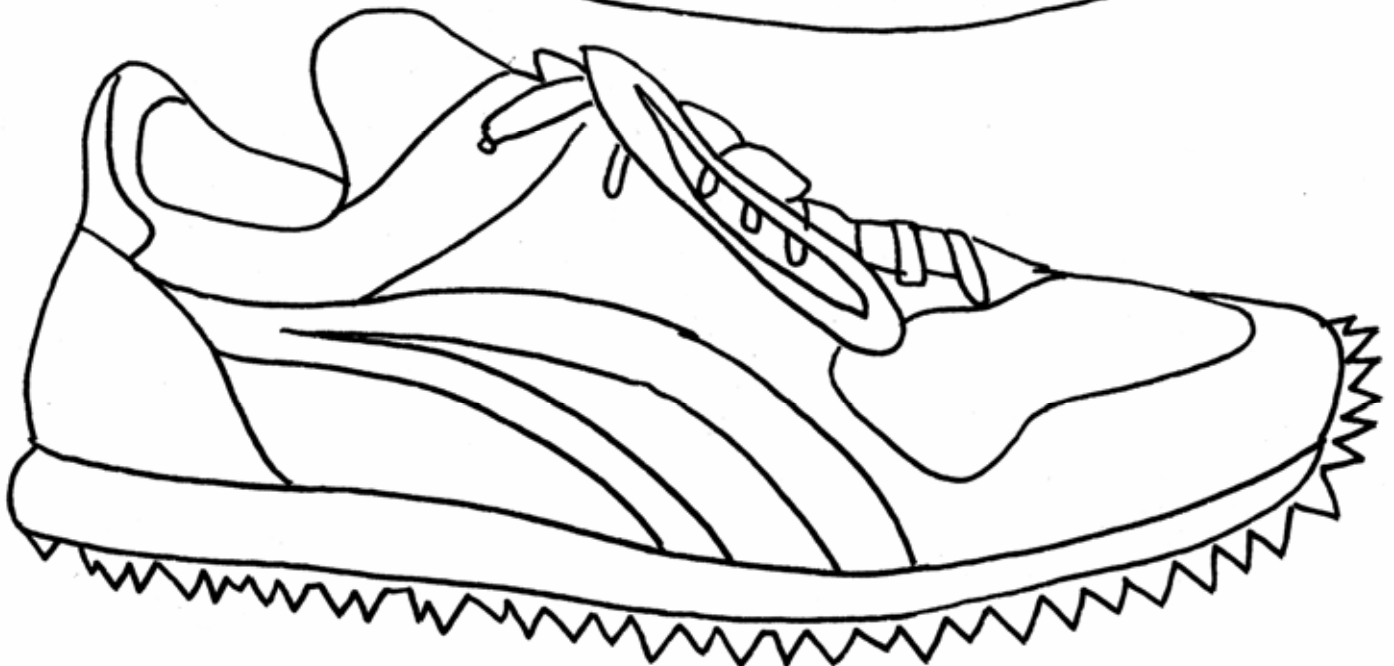
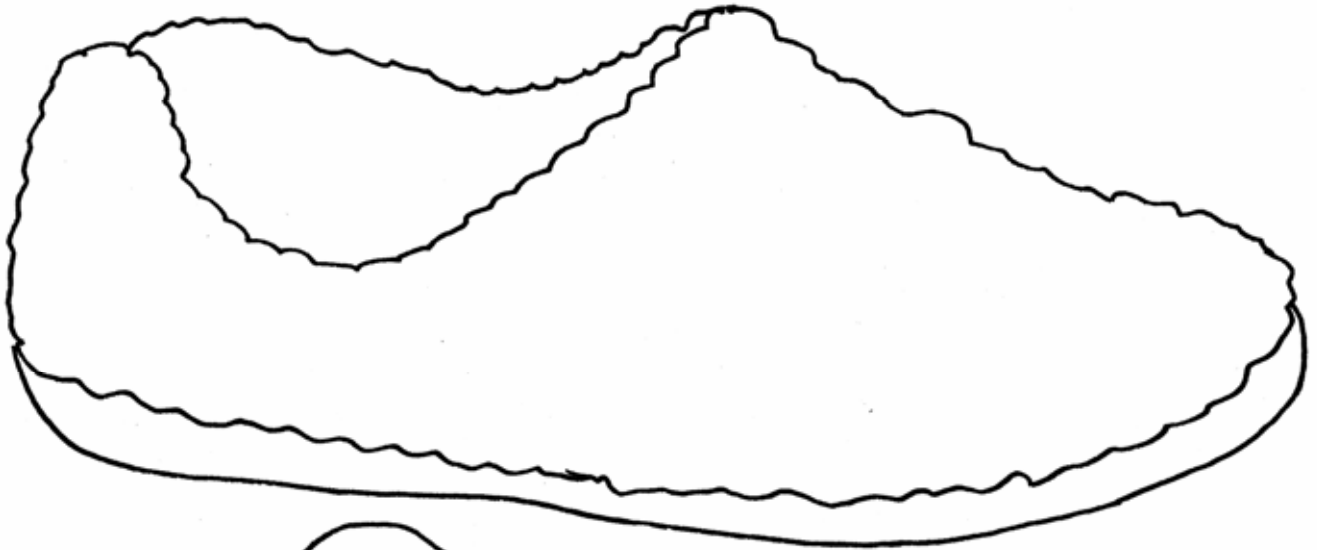

## SHOES 2

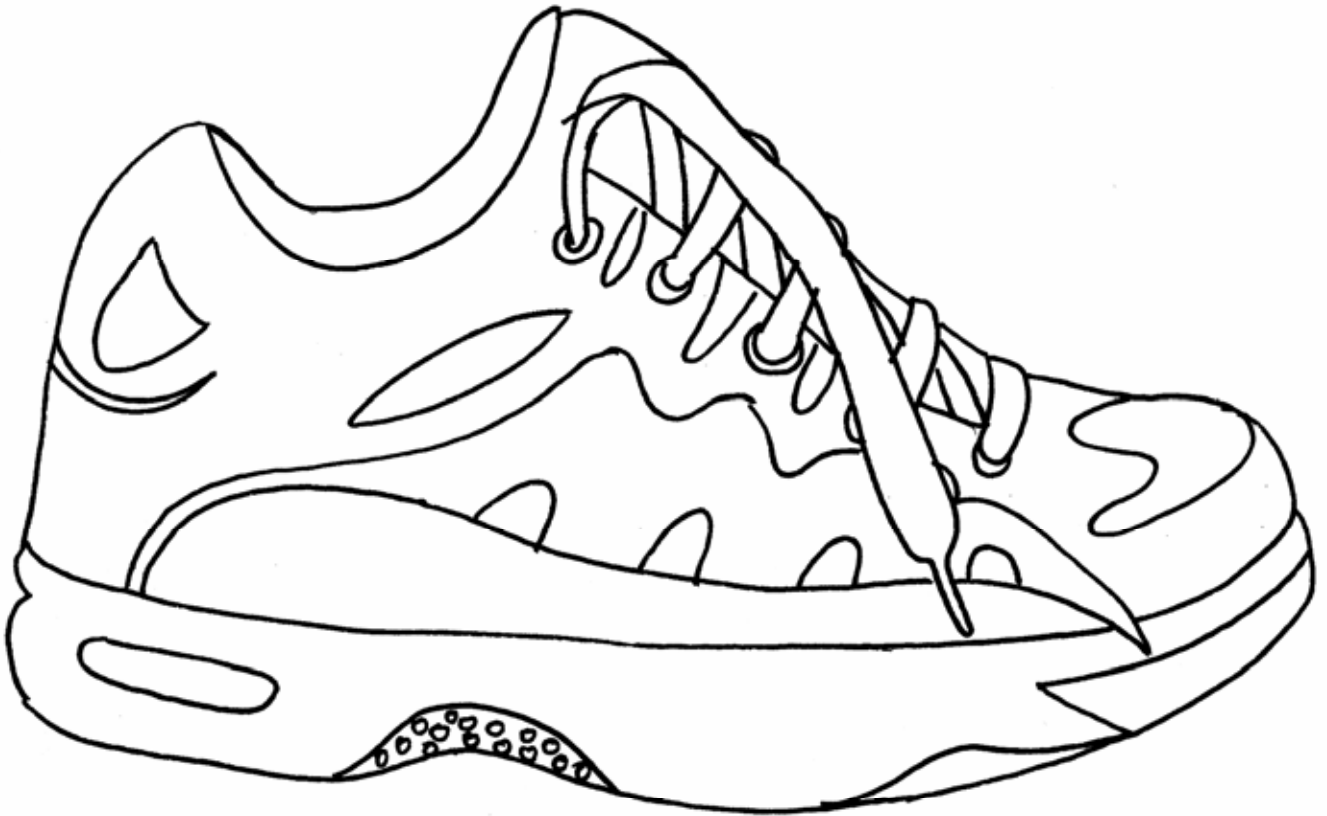

## SHOES 3

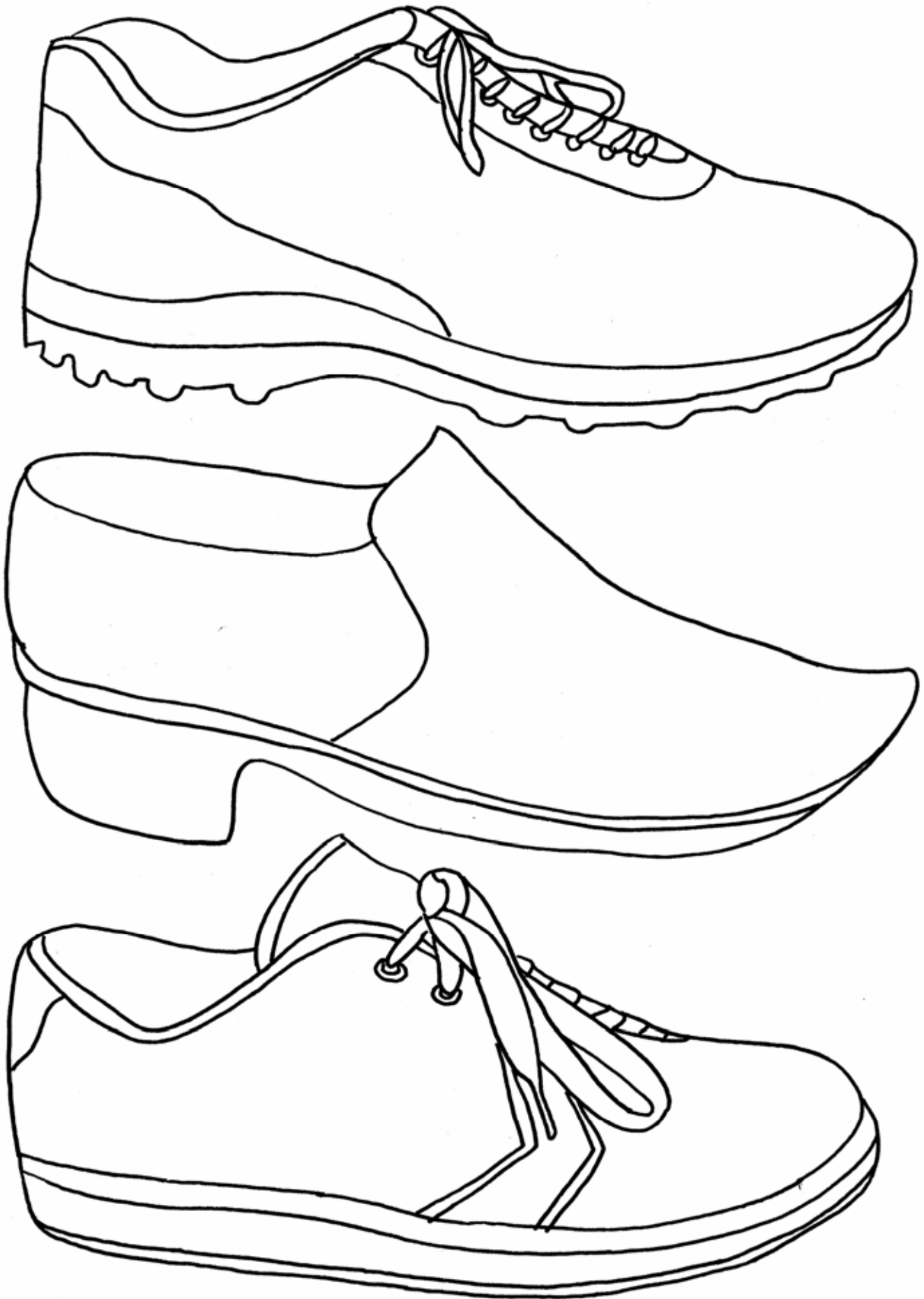

## SHOES 4

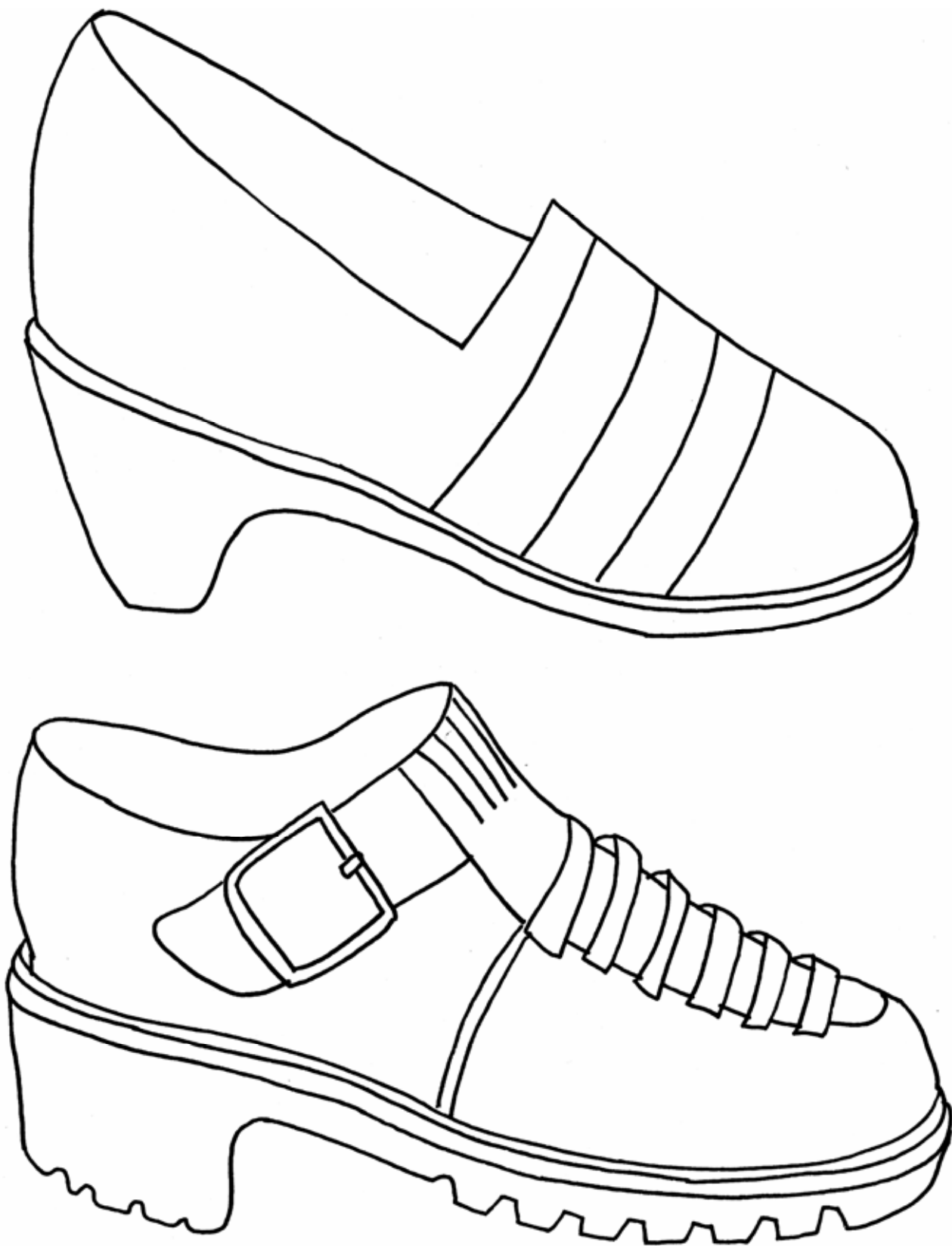

## BACK WHEELS

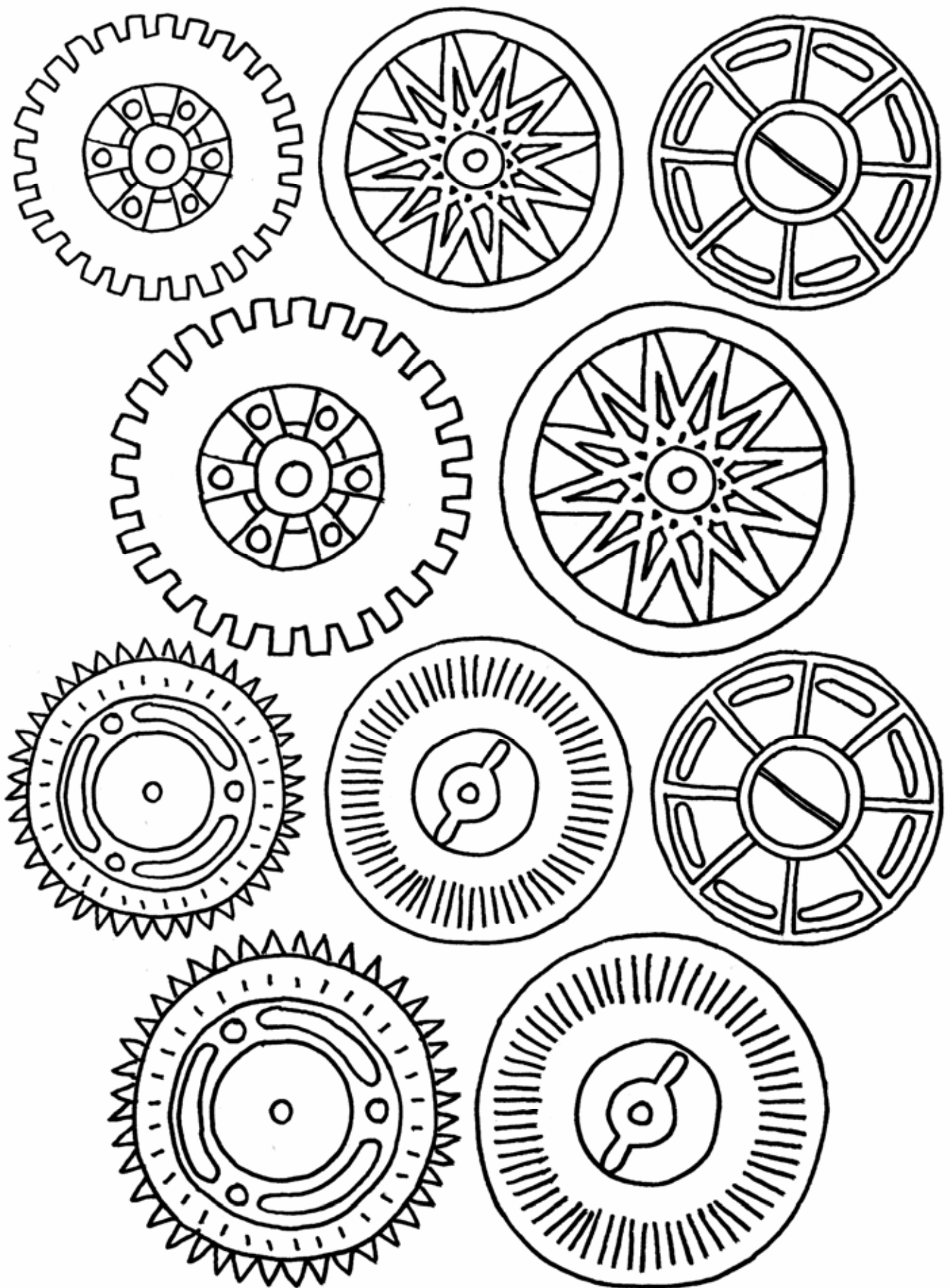

## FRONT WHEELS

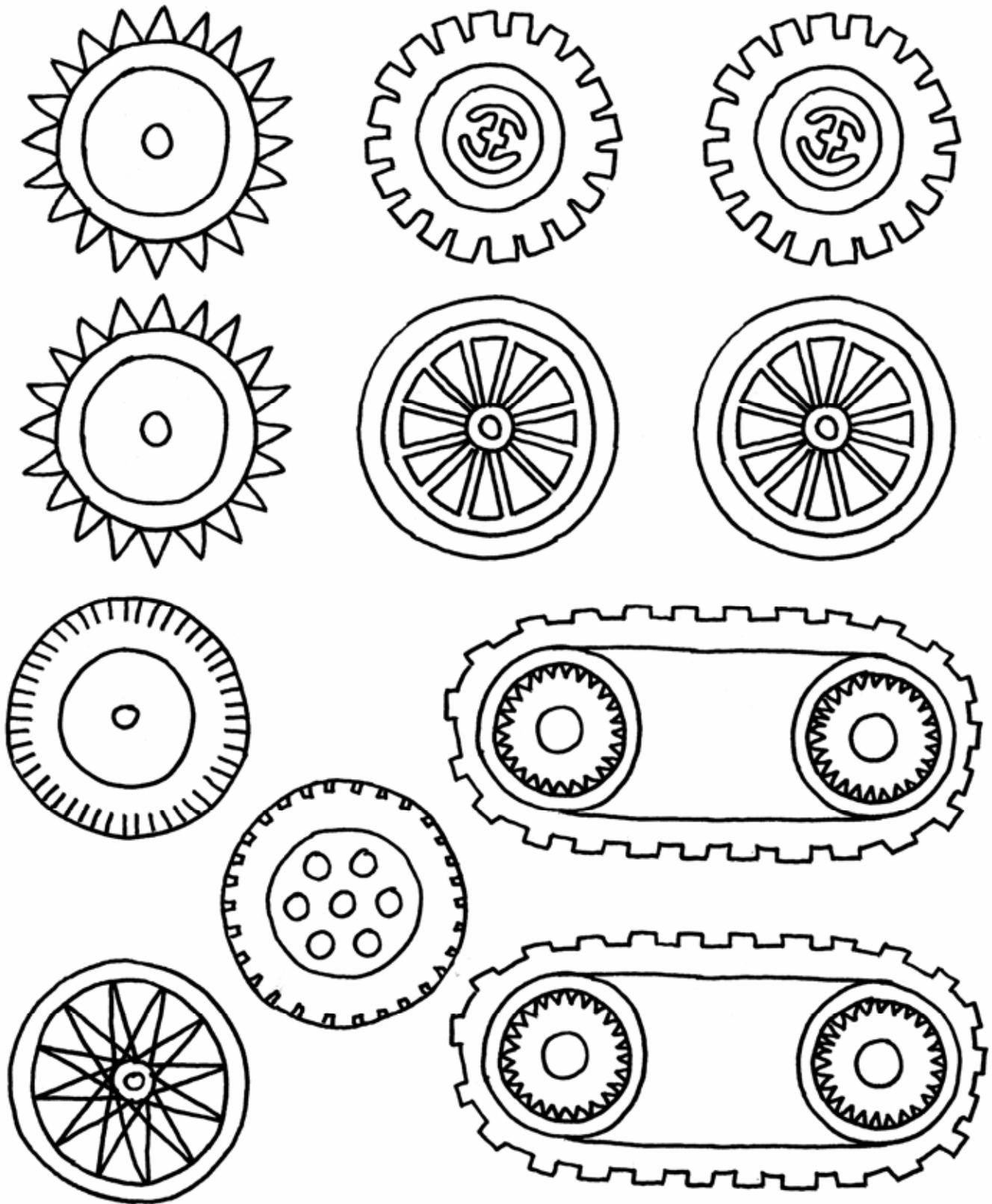

# MOTORS

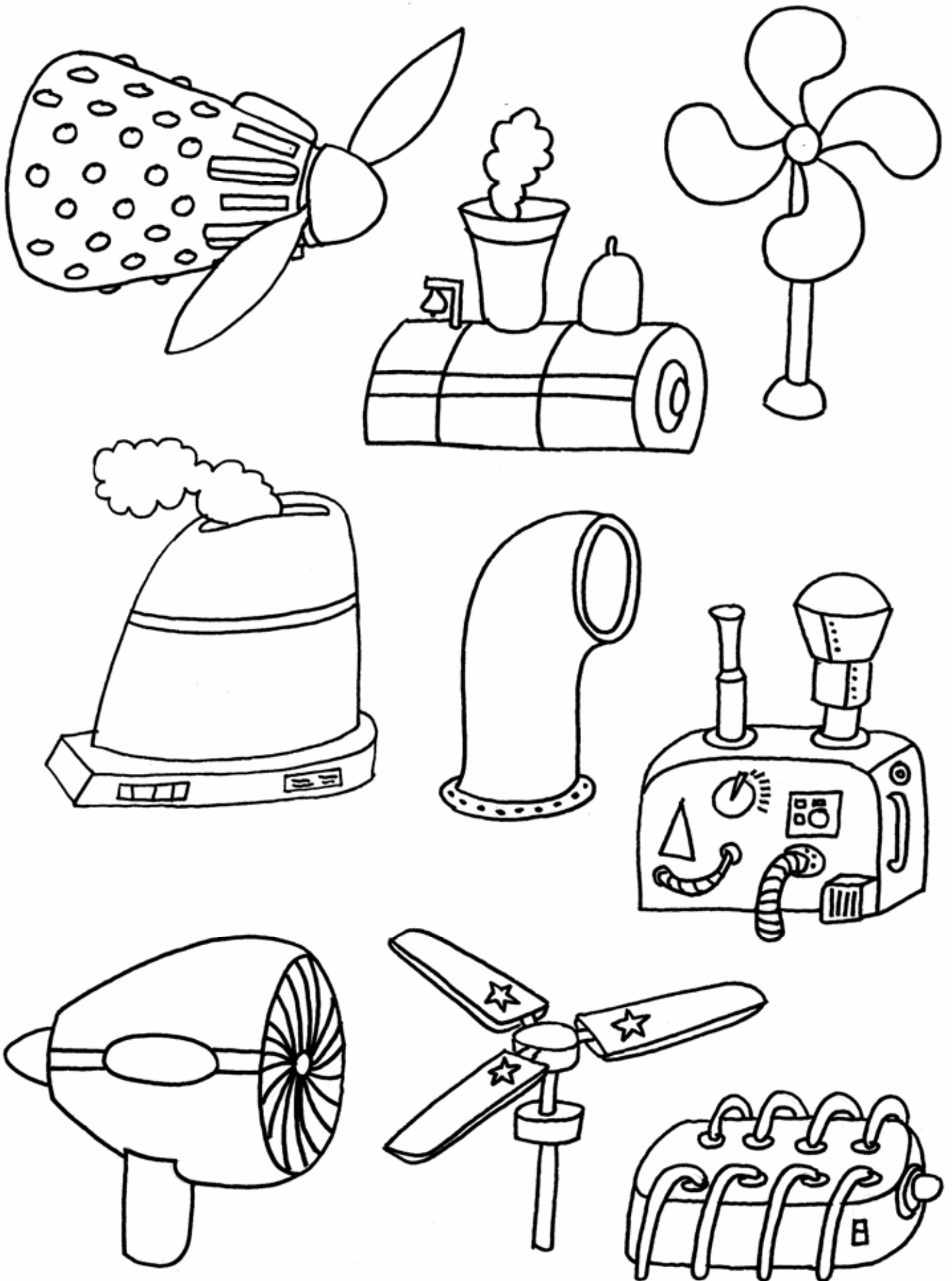



SAILS

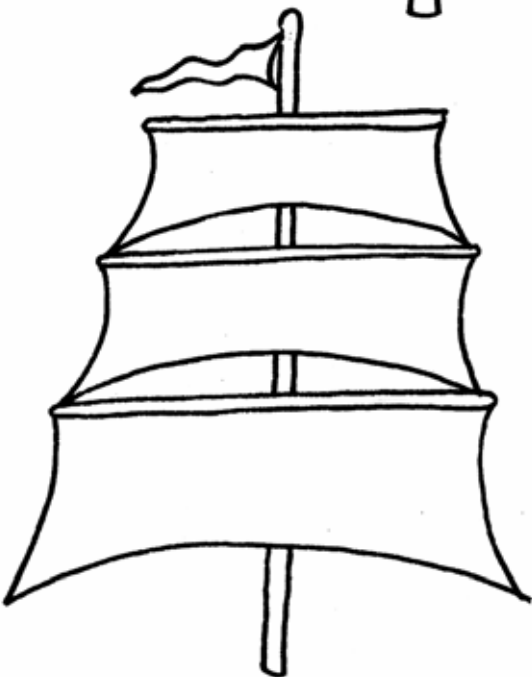
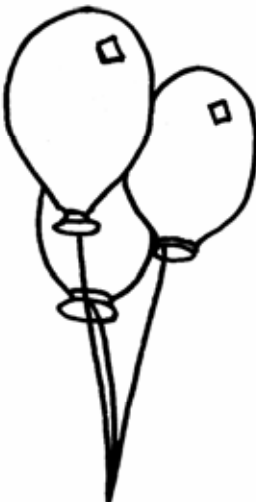
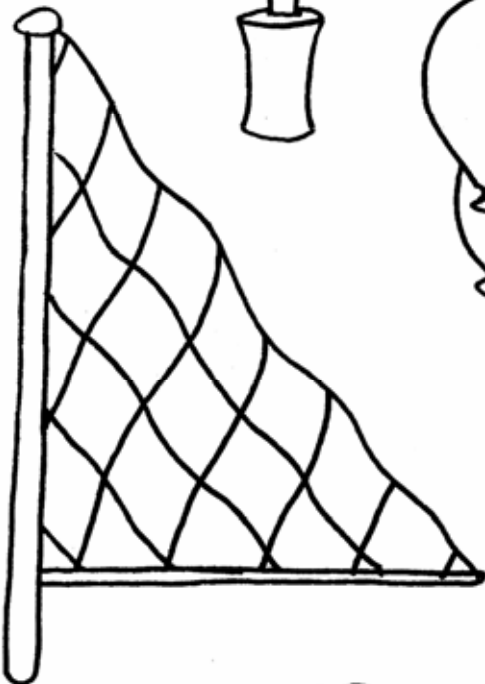
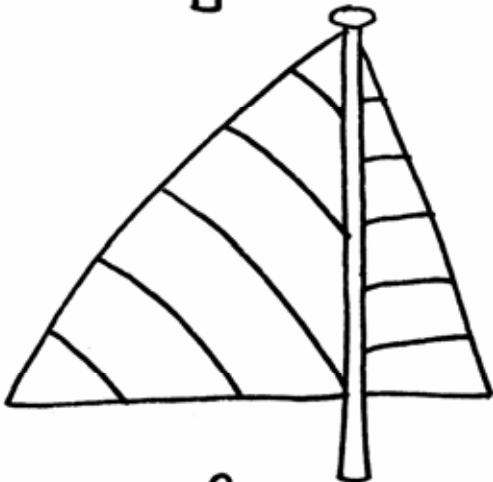
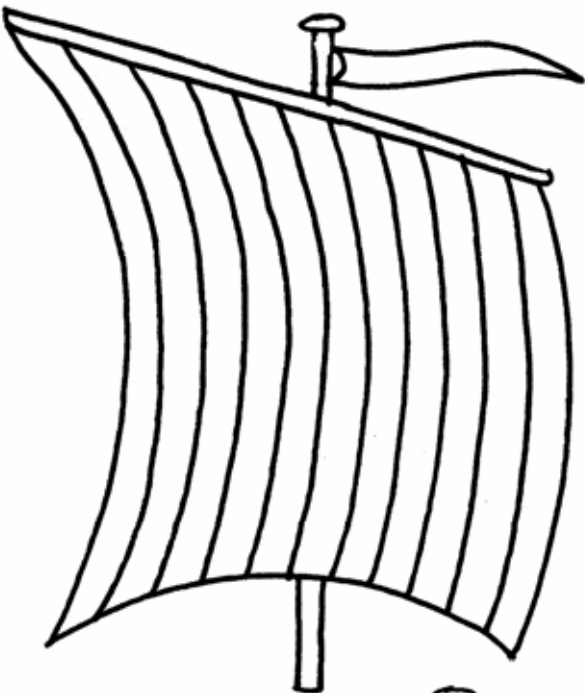

## DRIVERS

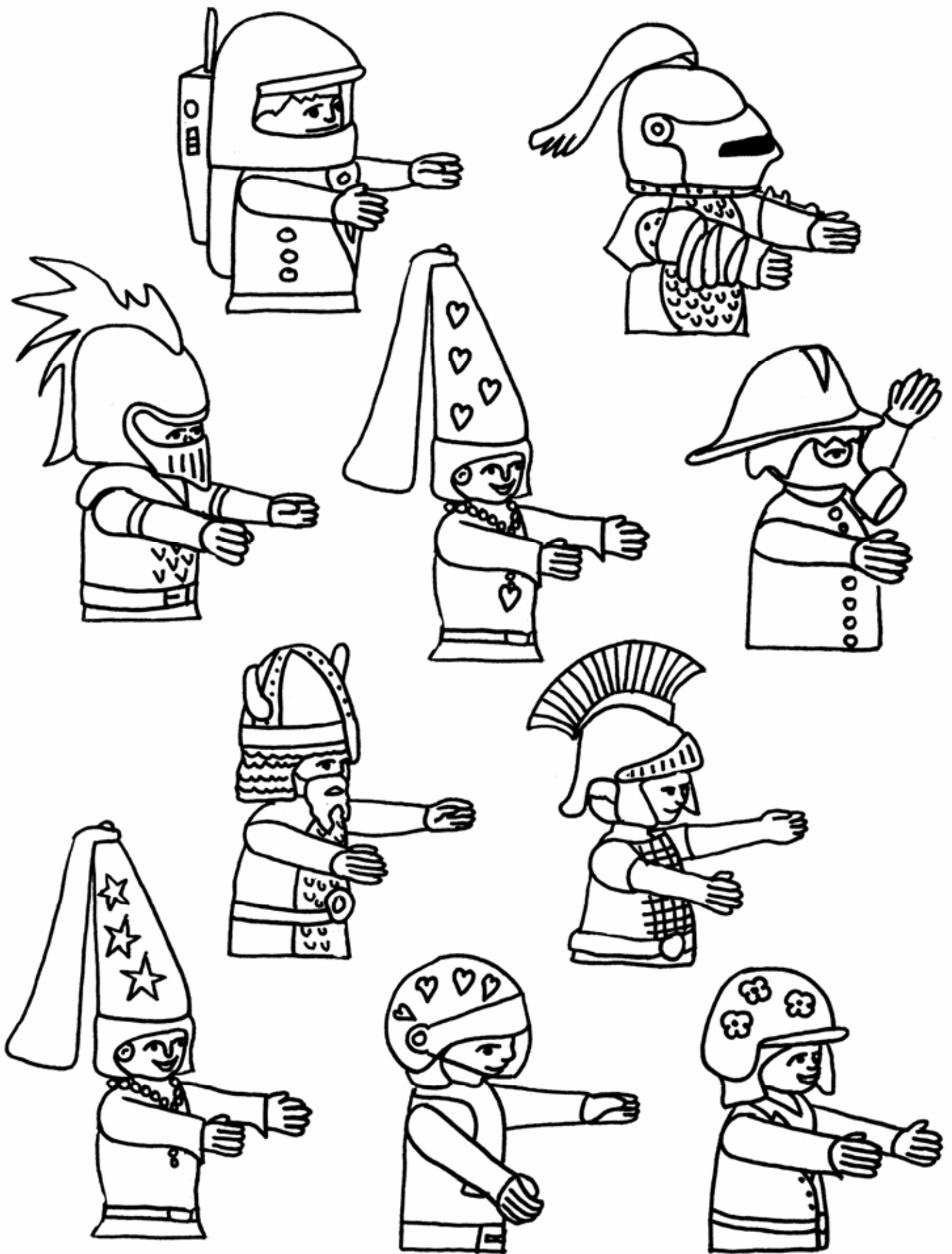

## RACING NUMBER

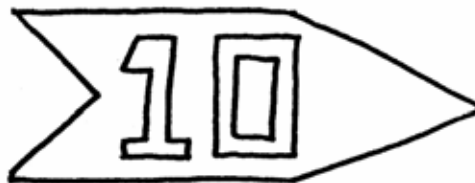
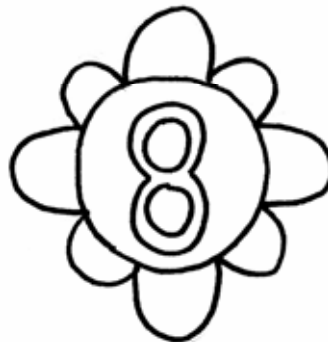
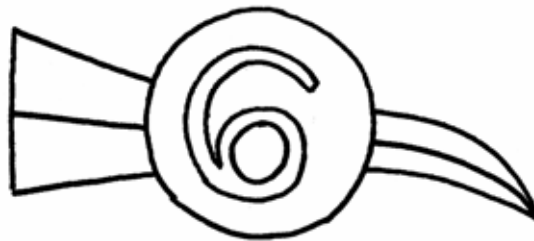
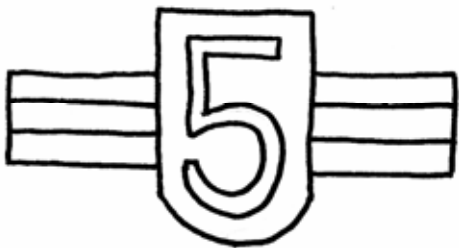

## STEERING WHEEL/ LIGHTS

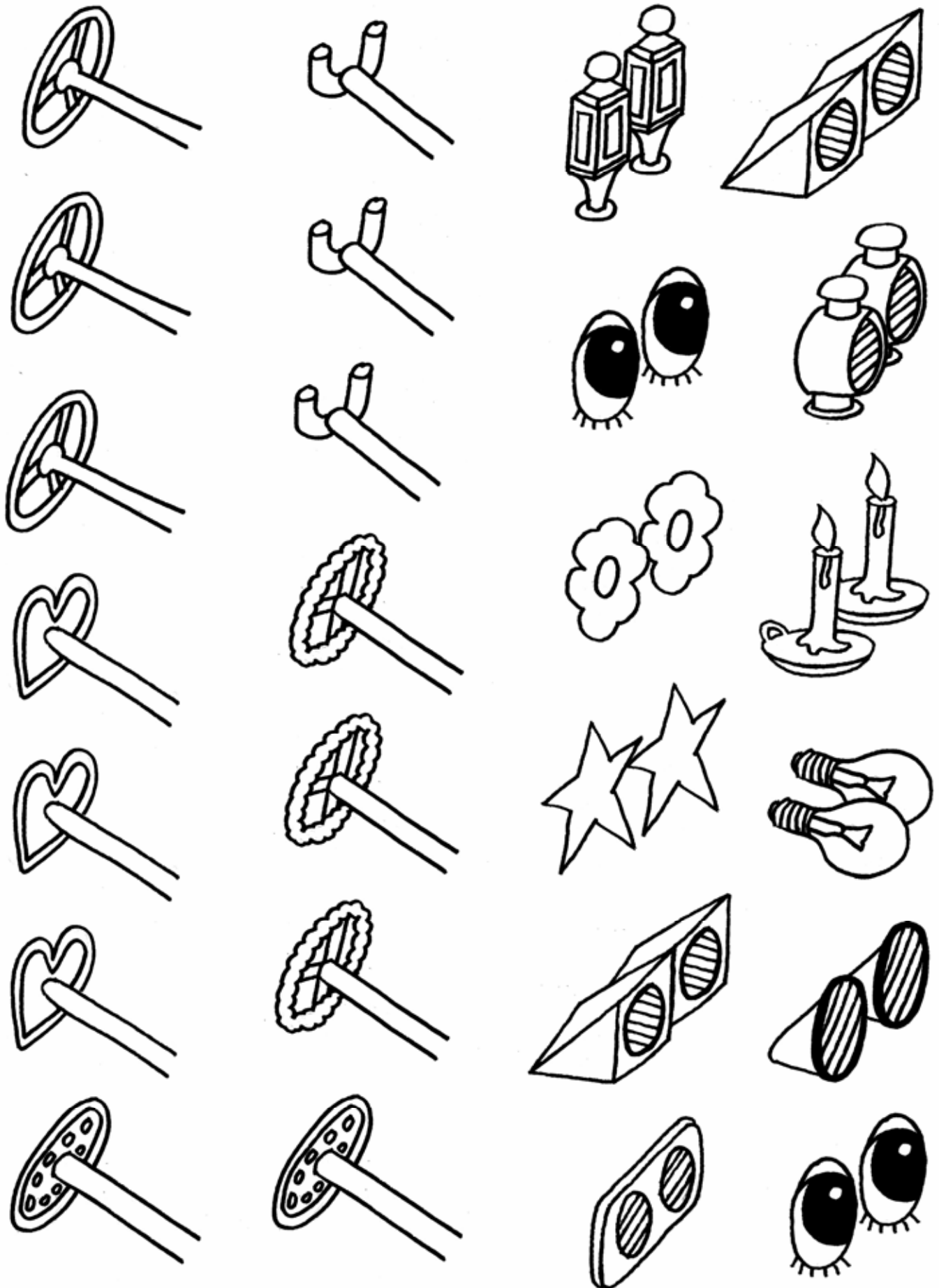

## EXHAUST AND FUMES

